

No-till on the Plains **ANNUAL WINTER CONFERENCE**

JAN. 25 & 26, 2022 • WICHITA, KANSAS

QUESTIONS? Email Swaffar@notill.org
or call (785) 210-4549

June 25, 2021

Dear Sponsors and Exhibitors,

We are excited to announce our return to an in-person Conference in 2022. It has been a long road to another Conference, but we have taken this opportunity to evaluate our events and streamline our process. We will hold the Conference January 25 and 26, 2021 in Wichita, KS but at a new facility: The Wichita Marriott.

The Marriot is a smaller hotel that will not accommodate more than 500 guests for our sessions. Even though this space is smaller, we know the intimate networking possibilities will be superior to our previous space.

On the included map you will see our sponsor spots will all be located very close to the meeting rooms and dining rooms. You will get more walk by traffic at your exhibits in this new facility. However, exhibit spaces will be overall smaller this year to accommodate the configuration of the facility.

There are several hotels in the surrounding area for attendees and sponsors. I would suggest you get your rooms early if you want to stay at the Marriott.

You will find the sponsor benefits and information about the conference for the large in-person event we are planning in the following pages. If you have any questions, please contact us at Swaffar@notill.org or call us (785) 210-4549.

We look forward to celebrating again in person January 25-26, 2022, in Wichita, Kansas!

Sincerely,

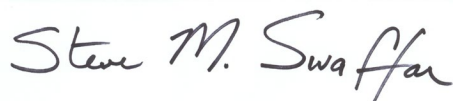

Steve Swaffar
Executive Director

No-till on the Plains **ANNUAL WINTER CONFERENCE**

JAN. 25 & 26, 2022 • WICHITA, KANSAS

QUESTIONS? Email Swaffar@notill.org
or call (785) 210-4549

Important Details

1. Move-in/Move-out

Sponsors may move in from 10:00 a.m. to 4:30 p.m. on Monday, January 24 or between 7:00 - 8:00 a.m. Tuesday Jan 25. On Wednesday, Jan. 26, sponsors may pack-up and move out after 3:30 pm. On Monday Jan 24, will be hosting our Beginners and Advanced Workshops on Monday so there is an opportunity for booth traffic on Monday too.

2. Booth Hours

Monday, Jan. 24: 10:00 a.m. – 4:00 p.m. (optional for fundamentals and advanced workshops)

Tuesday, Jan. 25: 8:00 a.m. to 7:00 p.m.

Wednesday, Jan. 26: 8:00 a.m. to 3:30 p.m.

Attendees may view exhibits any time during open hours. You are welcome to have your booth set up and open to attendees on Monday. All sponsors and exhibitors, must set up booths between 10:00 am - 4:30 p.m. on Monday, or between 7:00 -8:00 a.m. Tuesday.

Monday – January 24, 2022

7:00 a.m. - Registration opens

8:30 - Fundamentals and Advanced workshops running concurrently in Marriott Ballrooms

10:00 Break (20 minutes)

10:20 a.m. - Fundamentals and Advanced workshop sessions

Noon - Lunch for both workshops

1:30 - Fundamentals and Advanced workshop sessions

3:00 Break (20 minutes)

3:20 - Fundamentals and Advanced workshop sessions

4:45 Adjourn for the day

Tuesday - January 25, 2022

7:00 - Registration Opens

8:30 a.m. - Keynote Speaker – Kansas Grand Ballroom

10:00 a.m. – Break (30 minutes)

10:30 a.m. - Breakout Sessions – Marriott meeting rooms

11:30 a.m. - Lunch

1:00 p.m. - Breakout Sessions – Marriott meeting rooms



No-till on the Plains **ANNUAL WINTER CONFERENCE**

JAN. 25 & 26, 2022 • WICHITA, KANSAS

QUESTIONS? Email Swaffar@notill.org

or call (785) 210-4549

2:10 p.m. - Sponsor Breakout Sessions (Tier 1)
3:10 p.m. – Break (thirty minutes)
3:40 p.m. – Breakout Sessions – Marriott meeting rooms
4:50 p.m. - Breakout Sessions – Marriott meeting rooms
5:50 – 7:30 PM - Networking Reception in
Hallways and meeting rooms

Schedule subject to change

Wednesday - January 26, 2022

7:30 a.m. - Registration Opens
8:30 a.m. - Keynote Speaker – Kansas Grand Ballroom
10:00 a.m. – Thirty-minute break
10:30 a.m. – Breakout- Marriott meeting rooms
11:30 a.m. - Lunch
1:00 p.m. - Breakout Sessions- Marriott meeting rooms
2:10 p.m. - Breakout Sessions- Marriott meeting rooms
3:20 p.m. - Breakout Session- Marriott meeting rooms

Sessions end at 4:30 p.m.

3:30 p.m. – Booth teardown

On Jan. 25, Registration opens at 7:00 a.m. with Keynote session beginning at 8:30 a.m. On Jan. 26, Keynote session begins at 8:30 a.m. There will be an extended lunch and 30-minute breaks for attendee-exhibitor interaction both days.

3. .

4. Online Sponsor Registration and Contracts

Please complete your registrations and contracts at www.notill.org. You may complete your contact information, reserve your space, pay securely online via PayPal and order add-ons such as electricity, Internet and other necessary items all in one convenient location. This online process will expedite your registration and improve the trade show experience. Register at www.notill.org

2022 Sponsor Levels

	Tier 1 Sponsor	Tier 2 Sponsor
Investment	\$7500	\$5000
# Available	4	11
Exhibit Space	Any available booth space	Any Available booth space after T1 sponsors are placed
Exhibit Sizes	18x'-8' (3) 6' draped tables, 2 chairs, back and side drape, trashcan.	6' x 8' - (1) 6' draped table, 2 chairs, back and side drape, trashcan.
Electricity & Internet	Included	Included
Booth Enhancements	Included upon request	Available upon request, at sponsor cost
Complimentary Registrations	4	2
Breakout Session	Exclusive 60-minute session during conference breakouts	Not available
Attendee List	Included (Name, address, email)	Included (Name, address, email)
Complimentary Invitation to NTOP WC events	Invitation for 4 to all events around WC (Monday's workshop, Winter Conference 2-day pass, Tuesday's Networking Banquet)	Invitation for 2 to all events around WC (Monday's workshop, Winter Conference 2-day pass, Tuesday's Networking Banquet)
Conference Proceedings	Company listing in sponsor directory	Company listing in sponsor directory
Conference Proceedings Ad	Full page - color ad	1/2 page - color ad



No-till on the Plains **ANNUAL WINTER CONFERENCE**

JAN. 25 & 26, 2022 • WICHITA, KANSAS

QUESTIONS? Email Swaffar@notill.org

or call (785) 210-4549

2022 Sponsor Levels

	Tier 1 Sponsor	Tier 2 Sponsor
Recognition		
Showcase 1 year on website and at all NTOP events	Yes	No
Logo on advertising	Yes	Yes
Listed in news releases	Yes - 5 minimum	Yes - 3 minimum
Logo on on-site signage	Yes	Yes - with other Tier 2 sponsors
Logo on a slide on jumbo screen before sessions	Yes - logo on own slide	Yes - logo with other Tier 2 sponsors
1 minute commercial before Gen Sess.	Yes	No
Sponsor spotlight email blast	Yes	Yes
Social Media Mentions prior to WC	5	3
One promotional piece and some small giveaway in attendee packet	Yes	Yes

No-till on the Plains **ANNUAL WINTER CONFERENCE**

JAN. 25 & 26, 2022 • WICHITA, KANSAS

QUESTIONS? Email Swaffar@notill.org
or call (785) 210-4549

Parking

Parking is available at the hotel.

Sponsor Checklist

Submit your contract and payment online at notill.org. Sponsor booth locations are first-come, first-serve. Your space is not secured until payment is received. Pay securely online via PayPal during registration or mail a check as soon as possible to No-till on the Plains, P.O. Box 81, Berryton, KS 66409.

	TIER 1 SPONSOR	TIER 2 SPONSOR
Email print-ready advertisement (PDF or JPG)	Dec. 1 Ad size: WITHOUT BLEED: 8" wide by 10.5" tall, WITH BLEED: 8.75" wide by 11.25" (Keep text within safe space of 8.25" by 10.75", includes .125" on each edge for bleed)	By Dec. 1 Ad size: 7.5" wide by 4.875" tall
Submit commercial	By Dec. 15 1-min. commercial	
Email breakout session presentation	By Jan. 10	
Email list of employee names for conference badges	4y Jan. 10 (8 badges)	By Jan. 10 (2 badges)



No-till on the Plains ANNUAL WINTER CONFERENCE

JAN. 25 & 26, 2022 • WICHITA, KANSAS

QUESTIONS? Email Swaffar@notill.org

or call (785) 210-4549

Marriott Ground Floor Layout

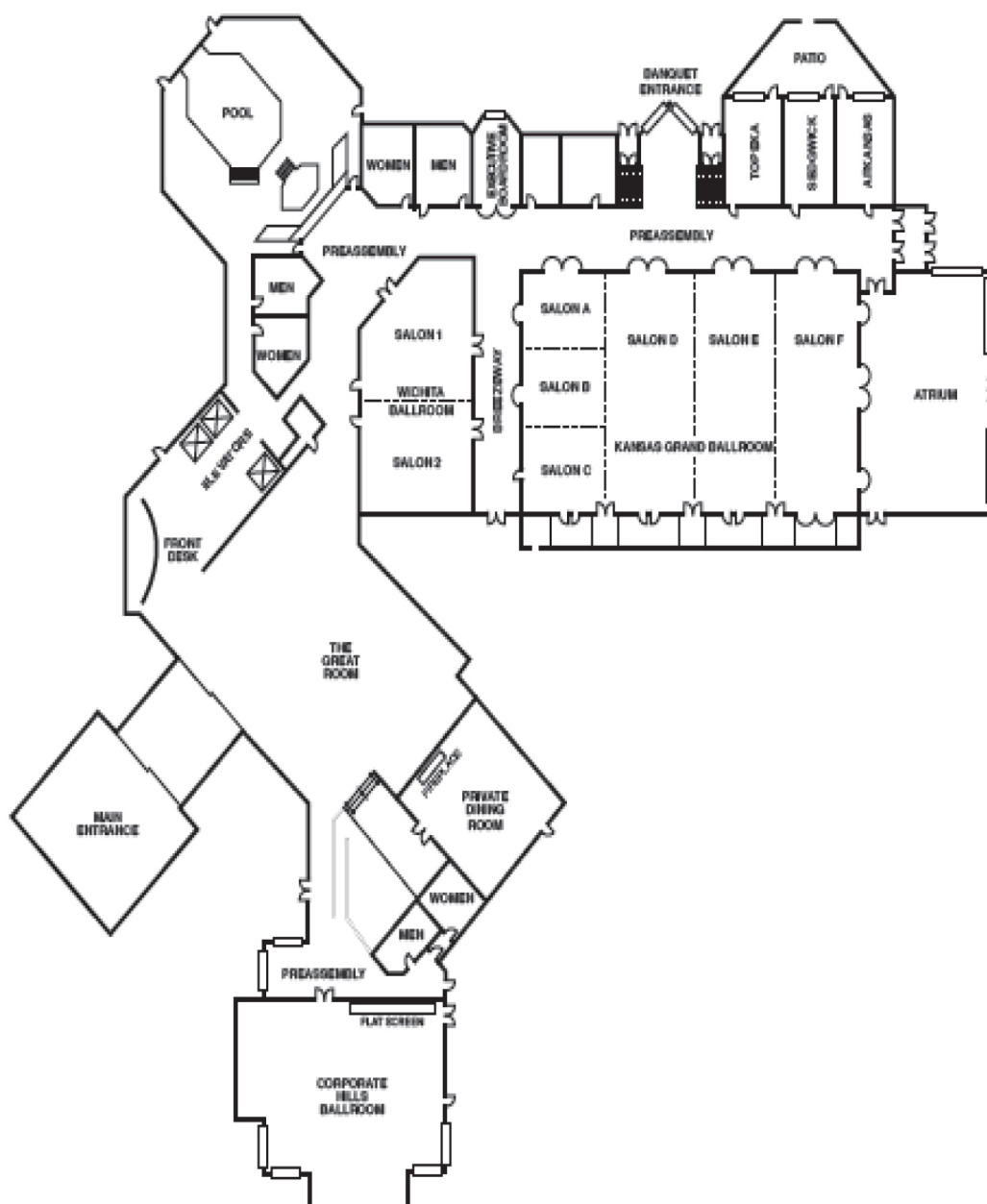



No-till on the Plains **ANNUAL WINTER CONFERENCE**

JAN. 25 & 26, 2022 • WICHITA, KANSAS

QUESTIONS? Email Swaffar@notill.org

or call (785) 210-4549

Marriott Sponsor Booth Layout

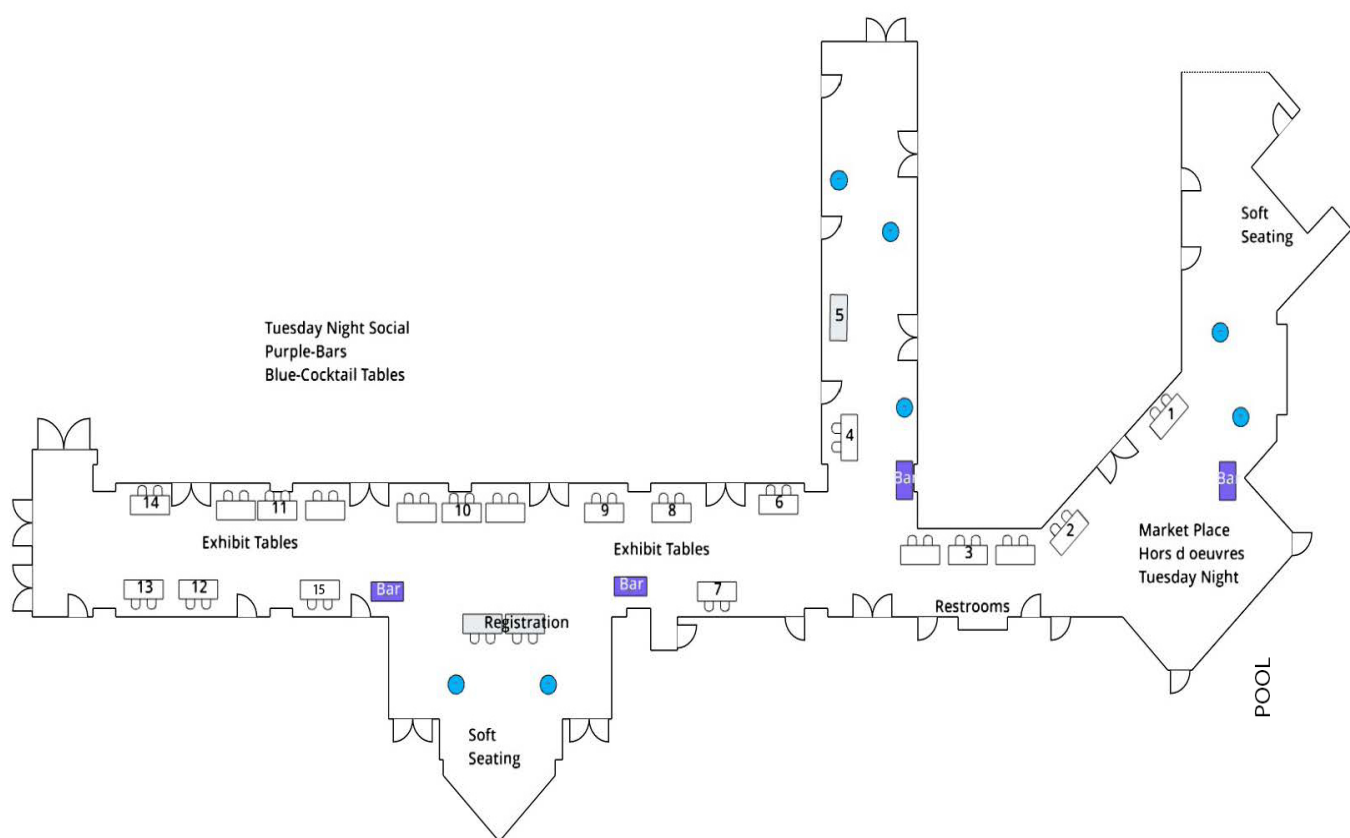

No-till on the Plains **ANNUAL WINTER CONFERENCE**

JAN. 25 & 26, 2022 • WICHITA, KANSAS

QUESTIONS? Email Swaffar@notill.org

or call (785) 210-4549

Sponsor Agreement

We hereby make application for sponsorship/exhibitor according to the official floor plan to be used for an exhibit at the No-till on the Plains, Inc. Winter Conference at the Wichita Marriott on Jan. 25-26, 2022, to be conducted by the No-till on the Plains, Inc. All sponsor/exhibitor rules and information governing the No-till on the Plains, Inc. Winter Conference are accepted by us, and made part of this contract, and we agree to comply with all of them, taking the space for exhibition purposes under the terms and conditions set forth below.

Exhibit Hours

- Monday, Jan. 24: Sponsor move-in as scheduled; registration check-in required
- Tuesday, Jan. 25: 8:00 a.m. to 6:30 p.m. (Facility open at 7:00 a.m.)
- Wednesday, Jan. 26: 8:00 a.m. to 4 p.m.

Move-in/Move-out

- Move-in: Monday, Jan. 24, at 10 a.m. – 4:00 p.m. for move-in and closes at 5:00 p.m. sharp.
- Move-in Tuesday, January 25, 7:00-8:00 a.m.
- All booth spaces will be pre-marked to ease with set-up.
- On Wednesday, Jan. 26, sponsors may pack-up and move out only after 4:00 p.m. All displays must be removed by 6:30 p.m., Jan. 26.
- You may request information to have booth items shipped to the conference facility, please contact Steve to request the shipping information.

Name Badge Policies

Name badges must be worn during the entire show. A name badge must be purchased for each person working the exhibit and may not be exchanged between sponsor representatives working different days.

Sponsor Packets and Check-in

Sponsor packets containing show information and name badges must be picked up at the appropriate registration area (Monday or Tuesday morning).

Booth Furnishings

- Refer to the sponsorship table in the sponsorship packet for included booth furnishings. Someone will contact you in November for furnishings requests.
- Electricity and wireless Internet is available throughout the Marriott and included for sponsors/exhibitors. Bring your own extension cord.
- All items on display must lie within the four boundaries of the assigned exhibit area.



Agriculture Systems Modeling Nature



notillorg

#notill2022



NoTillOnThePlains

www.notill.org

No-till on the Plains **ANNUAL WINTER CONFERENCE**

JAN. 25 & 26, 2022 • WICHITA, KANSAS

QUESTIONS? Email Swaffar@notill.org

or call (785) 210-4549

Cancellation Policy

Cancellation of this contract will be granted if No-till on the Plains, Inc. is notified in writing. Exhibitors will be charged a 25% fee for cancellation prior to Dec. 31, 2021. The lessee will be held responsible for the entire rental fee after Jan. 1, 2022.

Liability

Lobby and hallway areas are not secure areas. Please plan to lock up or protect any valuable items brought to the Conference.

It is expressly understood and agreed between the sponsor and No-till on the Plains, Inc. that No-till on the Plains, Inc., its members, and the Wichita Marriott will not be held responsible for any loss of, or damage to, goods and property of sponsors and sponsors' employees. Each sponsor, upon signing a contract/application for space, expressly releases No-till on the Plains, Inc. from, and agrees to indemnify them against all claims. By accepting the contract, sponsor agrees to all of the policies of the hotel.

Contract Acceptance

When this contract is accepted, No-till on the Plains, Inc. agrees to give us the use of the space, to be used by us in consideration of and for the purpose and time aforesaid. No-till on the Plains, Inc. agrees to the terms herein stated, and to the terms and conditions set forth above.

Please contact Steve Swaffar, No-till On the Plains Executive Director, at Swaffar@notill.org or 785-210-4549 with questions. We look forward to having your support for regenerative agriculture producers!